

2x Adapter  $\varnothing 41 \times 8$   
PB20-Pro

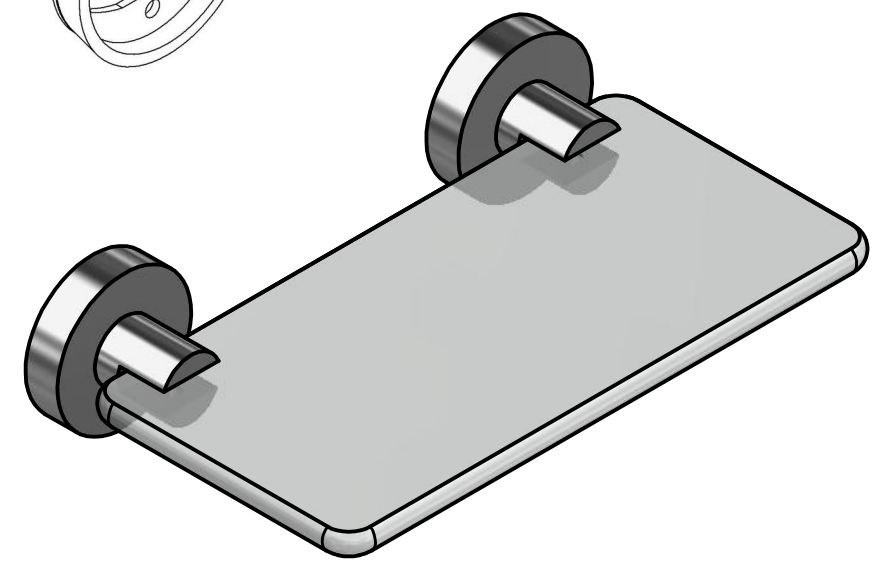

*tnwb-ID:*  
**Pro020** - Verchromt / chrome-plated:  
P02200-20 (Z) - 16718 (16719)

All dimensions in this drawing are nominal dimensions (in mm) and have tolerances  
Alle Maße in dieser Zeichnung sind Nennmaße (in mm) und haben Toleranzen

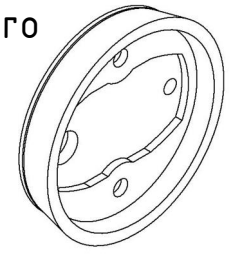
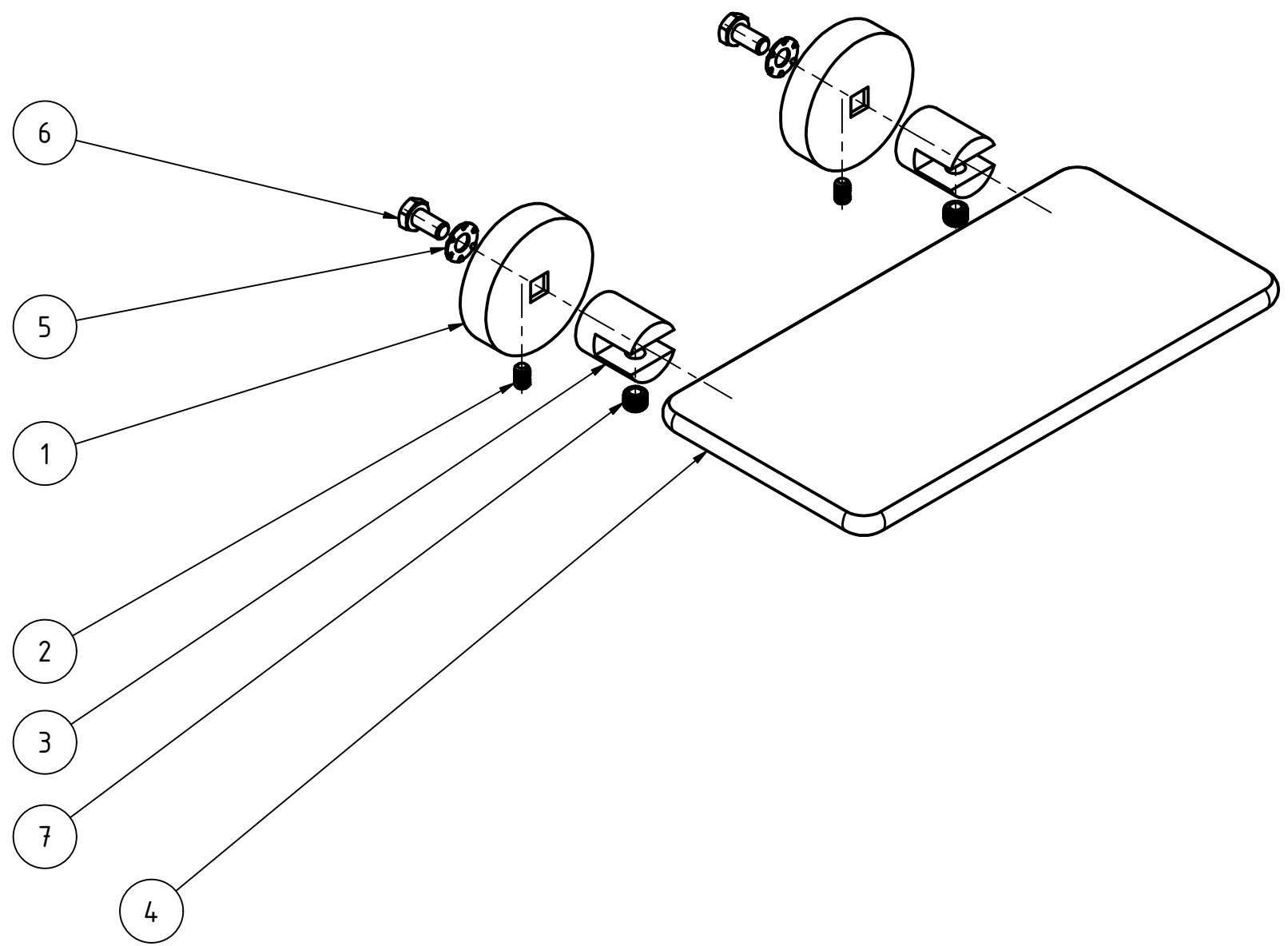

tnwb ID:  
16718 (17028) - P02200-20 (Z)

Origin  
17031 (17030) - P02200-45K (Z)

\* for details please find component drawing  
\* genaue Angaben siehe Einzelteilzeichnung

Bill of Material				
Pos.	Qty.	Part / Drw.-No.	Description	Material*
1	2	ERSATZPLATTA2_MfDrw	Rose, round D50 H12	Zamak 3
2	2	M5x8_Threated-Pin	M5x8	SUS201
3	2	S0200_3_MfDrw	Holder for Glass-Shelf	Zamak 3
4	1	EK200EG20	spare glass f. glass-shelf	Soda-Lime-Glass
5	2	Lock Washer	M6	iron, galvanized
6	2	Hexagon-bolt	M6x12	SUS201
7	2	rubber top screw M8x7	M8x7	SUS201

<b>tesa nie wieder bohren GmbH</b> Ein tesa Unternehmen		Tolerance DIN ISO 2768-c	Surface DIN-ISO 1302	Scale 1 : 2	Weight -
		Date	Name	Material: Surface treatment: Chrome-plated	
		drawn by	SchreMi	Part name glass-shelf	
		checked by	LakeSte	Article P02200-20	
		released	LakeSte	Drawing-No. P02200-20	
		Project / Series P02		Revision AA	Sheet Blatt 2/2 A3
Rev.	Date	Name	Releaser	\\HAUS014.001\Shares\Allgemein\Produktmanagement\12_CAD\02_Baugruppe\02.1_Baugruppen_Serie\02\02200-20.iam	